

STEP 5
INSTALL WHEELS
OVER AXLES

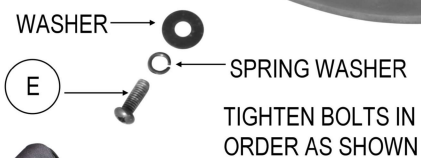

FINISH ASSEMBLY BY
TIGHTENING ALL BOLTS

STEP 6
INSTALL CLAMP
AT END OF PULL
TUBE WITH LOCK
FACING FORWARD

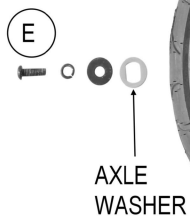
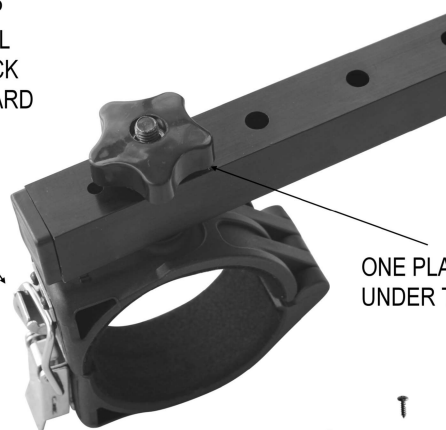

ONE PLASTIC WASHER
UNDER TUBE, ONE ON TOP

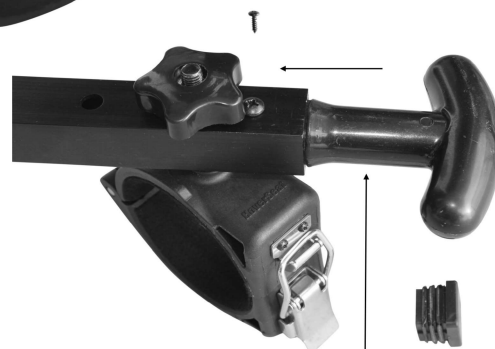

OPTIONAL: REMOVE
SQUARE CAP, INSTALL
T-HANDLE AND SECURE
WITH SMALL SCREW



HOVERSEAT XL CAN
BE STORED IN VERTICAL
POSITION

EYE BOLT CAN BE
USED TO ATTACH
PULL BEHIND CARGO